

# Tuffaloy tip adapters

TUFFALOY threaded electrode adapters are used to provide longer electrode holder life, by providing a changable tip socket in holders having threaded openings. Class 2 alloy.

| A<br>Pipe Thread<br>or Taper | B<br>Taper<br>Socket | C<br>Body<br>Size | D<br>Body<br>Length | E<br>Over-All<br>Length | Description  | Item<br>Number |
|------------------------------|----------------------|-------------------|---------------------|-------------------------|--------------|----------------|
| 1/2                          | 4RW                  | 1" Hex            | 1/4                 | 7/8                     | AD-124-.8    | 190-1408       |
|                              |                      |                   | 3/8                 | 1                       | AD-124-1.0   | 190-1410       |
|                              |                      |                   | 5/8                 | 1-1/4                   | AD-124-1.2   | 190-1412       |
|                              |                      |                   | 7/8                 | 1-1/2                   | AD-124-1.5   | 190-1415       |
|                              |                      |                   | 1-1/8               | 1-3/4                   | AD-124-1.7   | 190-1417       |
|                              |                      |                   | 1-3/8               | 2                       | AD-124-2.0   | 190-1420       |
|                              |                      |                   | 1-5/8               | 2-1/4                   | AD-124-2.2 * |                |
|                              |                      |                   | 1-7/8               | 2-1/2                   | AD-124-2.5   | 190-1425       |
|                              |                      |                   | 2-1/8               | 2-3/4                   | AD-124-2.7 * |                |
|                              |                      |                   | 2-3/8               | 3                       | AD-124-3.0   | 190-1430       |
|                              |                      |                   | 2-5/8               | 3-1/4                   | AD-124-3.2 * |                |
|                              |                      |                   | 2-7/8               | 3-1/2                   | AD-124-3.5   | 190-1435       |
|                              |                      |                   | 3-1/8               | 3-3/4                   | AD-124-3.7 * |                |
|                              |                      |                   | 3-3/8               | 4                       | AD-124-4.0   | 190-1440       |
| 4-3/8                        | 5                    | AD-124-5.0 *      |                     |                         |              |                |
| 1/2                          | 5RW                  | 1" Hex            | 1/4                 | 7/8                     | AD-125-.8    | 190-1508       |
|                              |                      |                   | 3/8                 | 1                       | AD-125-1.0   | 190-1510       |
|                              |                      |                   | 5/8                 | 1-1/4                   | AD-125-1.2   | 190-1512       |
|                              |                      |                   | 7/8                 | 1-1/2                   | AD-125-1.5   | 190-1515       |
|                              |                      |                   | 1                   | 1-5/8                   | AD-125-1.6 * |                |
|                              |                      |                   | 1-1/8               | 1-3/4                   | AD-125-1.7   | 190-1517       |
|                              |                      |                   | 1-3/8               | 2                       | AD-125-2.0   | 190-1520       |
|                              |                      |                   | 1-5/8               | 2-1/4                   | AD-125-2.2 * |                |
|                              |                      |                   | 1-7/8               | 2-1/2                   | AD-125-2.5   | 190-1525       |
|                              |                      |                   | 2-1/8               | 2-3/4                   | AD-125-2.7 * |                |
|                              |                      |                   | 2-3/8               | 3                       | AD-125-3.0   | 190-1530       |
|                              |                      |                   | 2-5/8               | 3-1/4                   | AD-125-3.2 * |                |
|                              |                      |                   | 2-7/8               | 3-1/2                   | AD-125-3.5   | 190-1535       |
|                              |                      |                   | 3-1/8               | 3-3/4                   | AD-125-3.7 * |                |
| 3-3/8                        | 4                    | AD-125-4.0        | 190-1540            |                         |              |                |
| 3-7/8                        | 4-1/2                | AD-125-4.5        | 190-1545            |                         |              |                |
| 5/8                          | 4RW                  | 1" Hex            | 1/4                 | 7/8                     | AD-584-.8    | 190-2408       |
|                              |                      |                   | 3/8                 | 1                       | AD-584-1.0 * |                |
|                              |                      |                   | 7/8                 | 1-1/2                   | AD-584-1.5 * |                |
|                              |                      |                   | 1-3/8               | 2                       | AD-584-2.0 * |                |
| 5/8                          | 5RW                  | 1" Hex            | 1/4                 | 7/8                     | AD-585-.8    | 190-2508       |
|                              |                      |                   | 3/8                 | 1                       | AD-585-1.0 * |                |
|                              |                      |                   | 5/8                 | 1-1/4                   | AD-585-1.2   | 190-2512       |
|                              |                      |                   | 7/8                 | 1-1/2                   | AD-585-1.5   | 190-2515       |
|                              |                      |                   | 1-1/8               | 1-3/4                   | AD-585-1.7   | 190-2517       |
|                              |                      |                   | 1-3/8               | 2                       | AD-585-2.0 * |                |
|                              |                      |                   | 1-7/8               | 2-1/2                   | AD-585-2.5 * |                |
|                              |                      |                   | 2-3/8               | 3                       | AD-585-3.0 * |                |
| 3-3/8                        | 4                    | AD-585-4.0 *      |                     |                         |              |                |
| 3/4                          | 5RW                  | 1.25              | 3/16                | 1-1/8                   | AD-345-1.1 * |                |
|                              |                      |                   | 7/16                | 1-3/8                   | AD-345-1.3 * |                |
|                              |                      |                   | 9/16                | 1-1/2                   | AD-345-1.5   | 190-3515       |
|                              |                      |                   | 13/16               | 1-3/4                   | AD-345-1.7   | 190-3517       |
|                              |                      |                   | 1-1/16              | 2                       | AD-345-2.0   | 190-3520       |
|                              |                      |                   | 1-9/16              | 2-1/2                   | AD-345-2.5   | 190-3525       |
|                              |                      |                   | 2-1/16              | 3                       | AD-345-3.0   | 190-3530       |
|                              |                      |                   | 2-9/16              | 3-1/2                   | AD-345-3.5   | 190-3535       |
| 3-1/16                       | 4                    | AD-345-4.0        | 190-3540            |                         |              |                |
| 3-9/16                       | 4-1/2                | AD-345-5.0        | 190-3545            |                         |              |                |
| 4-1/16                       | 5                    | AD-345-5.0        | 190-3550            |                         |              |                |
| 3/4                          | 6RW                  | 1.25              | 5/16                | 1-1/4                   | AD-346-1.2 * |                |
|                              |                      |                   | 7/16                | 1-3/8                   | AD-346-1.3 * |                |
|                              |                      |                   | 9/16                | 1-1/2                   | AD-346-1.5   | 190-3615       |
|                              |                      |                   | 1-1/16              | 2                       | AD-346-2.0   | 190-3620       |
|                              |                      |                   | 1-9/16              | 2-1/2                   | AD-346-2.5   | 190-3625       |
|                              |                      |                   | 1-13/16             | 2-3/4                   | AD-346-2.7 * |                |
|                              |                      |                   | 2-1/16              | 3                       | AD-346-3.0   | 190-3630       |
|                              |                      |                   | 2-9/16              | 3-1/2                   | AD-346-3.5   | 190-3635       |
| 3-1/16                       | 4                    | AD-346-4.0        | 190-3640            |                         |              |                |
| 3-9/16                       | 4-1/2                | AD-346-4.5        | 190-3645            |                         |              |                |
| 4-1/16                       | 5                    | AD-346-5.0        | 190-3650            |                         |              |                |
| 3/4                          | 7RW                  | 1.25              | 9/16                | 1-1/2                   | AD-347-1.5   | 190-3715       |
|                              |                      |                   | 1-1/16              | 2                       | AD-347-2.0   | 190-3720       |
|                              |                      |                   | 1-9/16              | 2-1/2                   | AD-347-2.5   | 190-3725       |
|                              |                      |                   | 2-1/16              | 3                       | AD-347-3.0   | 190-3730       |
|                              |                      |                   | 2-9/16              | 3-1/2                   | AD-347-3.5   | 190-3735       |
| 3-1/16                       | 4                    | AD-347-4.0        | 190-3740            |                         |              |                |
| 3-9/16                       | 4-1/2                | AD-347-4.5        | 190-3745            |                         |              |                |
| 4-1/16                       | 5                    | AD-347-5.0        | 190-3750            |                         |              |                |
| 4RW                          | 5RW                  | 7/8               | 1                   | 2                       | AD-45-2      | 190-4520       |
|                              |                      |                   | 2                   | 3                       | AD-45-3      | 190-4530       |
|                              |                      |                   | 3                   | 4                       | AD-45-4      | 190-4540       |
| 5RW                          | 4RW                  | 7/8               | 1/4                 | 1-1/8                   | AD-54-1      | 190-5410       |
|                              |                      |                   | 1                   | 2                       | AD-54-2      | 190-5420       |
|                              |                      |                   | 1-1/2               | 2-1/2                   | AD-54-2.5 *  |                |
|                              |                      |                   | 2                   | 3                       | AD-54-3      | 190-5430       |
| 3                            | 4                    | AD-54-4           | 190-5440            |                         |              |                |
| 5RW                          | 5RW                  | 7/8               | 1                   | 2                       | AD-55-2      | 190-5520       |
|                              |                      |                   | 1-1/2               | 2-1/2                   | AD-55-2.5 *  |                |
|                              |                      |                   | 2                   | 3                       | AD-55-3 *    |                |
|                              |                      |                   | 3                   | 4                       | AD-55-4 *    |                |
|                              |                      |                   | 4                   | 5                       | AD-55-5      | 190-5550       |
| 5RW                          | 6RW                  | 1" Hex            | 1-1/8               | 2                       | AD-56-2      | 190-5620       |
|                              |                      |                   | 1/4                 | 1-1/4                   | AD-64-1      | 190-6410       |
|                              |                      |                   | 1/4                 | 1-1/4                   | AD-65-1      | 190-6510       |
| 6RW                          | 5RW                  | 1" Hex            | 1/4                 | 1-1/2                   | AD-74-1      | 190-7410       |
|                              |                      |                   | 1/4                 | 1-1/2                   |              |                |
| 7RW                          | 5RW                  | 1" Hex            | 1/4                 | 1-1/2                   | AD-75-1      | 190-7510       |
|                              |                      |                   | 3/4                 | 2                       | AD-75-2      | 190-7520       |
|                              |                      |                   | 2-1/4               | 3-1/2                   | AD-73-3.5 *  |                |
|                              |                      |                   | 2-3/4               | 4                       | AD-75-4 *    |                |

\* Not commonly stocked - other adapters available upon request

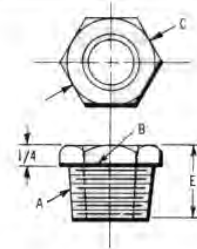

AD-124-.8, AD-125-.8,  
AD-584-.8, AD-585-.8

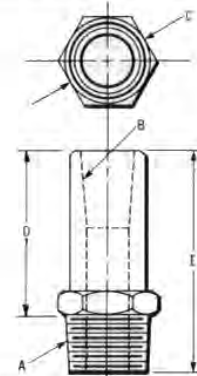

AD-124-1.0 to AD-124-4.0  
AD-125-1.0 to AD-125-4.0  
AD-345-1.5 to AD-347-5.0

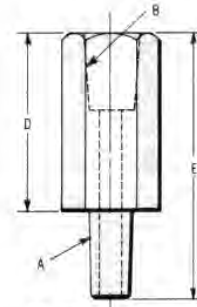

AD-45-2 to AD-45-4

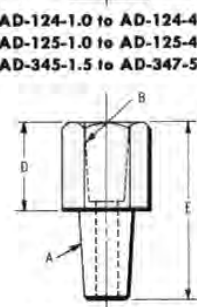

AD-54-1 to AD-75-2

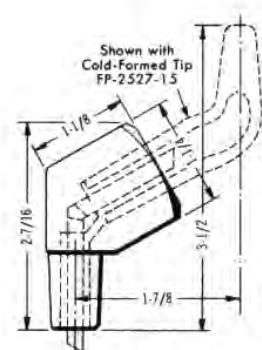

AD-55-30, for 5 RW Tip,  
Item No. 190-9553

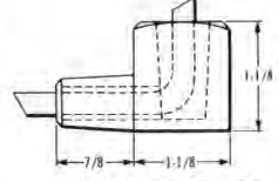

AD-55-90, for 5 RW Tip,  
Item No. 190-9559  
AD-54-90, for 4 RW Tip,  
Item No. 190-9549

AD-785-90E for 5 RW Tip,  
Item No. 190-9591

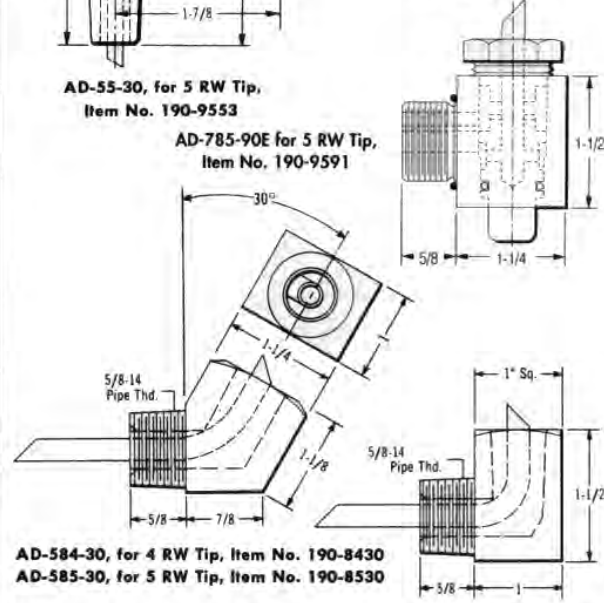

AD-584-30, for 4 RW Tip, Item No. 190-8430  
AD-585-30, for 5 RW Tip, Item No. 190-8530

AD-584-90, for 4 RW Tip, Item No. 190-8490  
AD-585-90, for 5 RW Tip, Item No. 190-8590